



CERTIFICATE

CERTIFIED THAT THE PLOT UNDER REFERENCE WAS SURVEYED BY ME ON 01/05/2024...

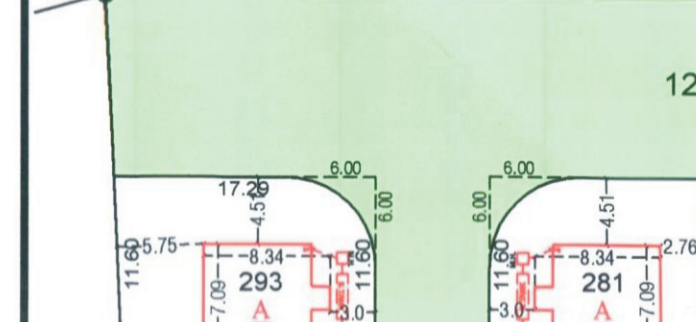
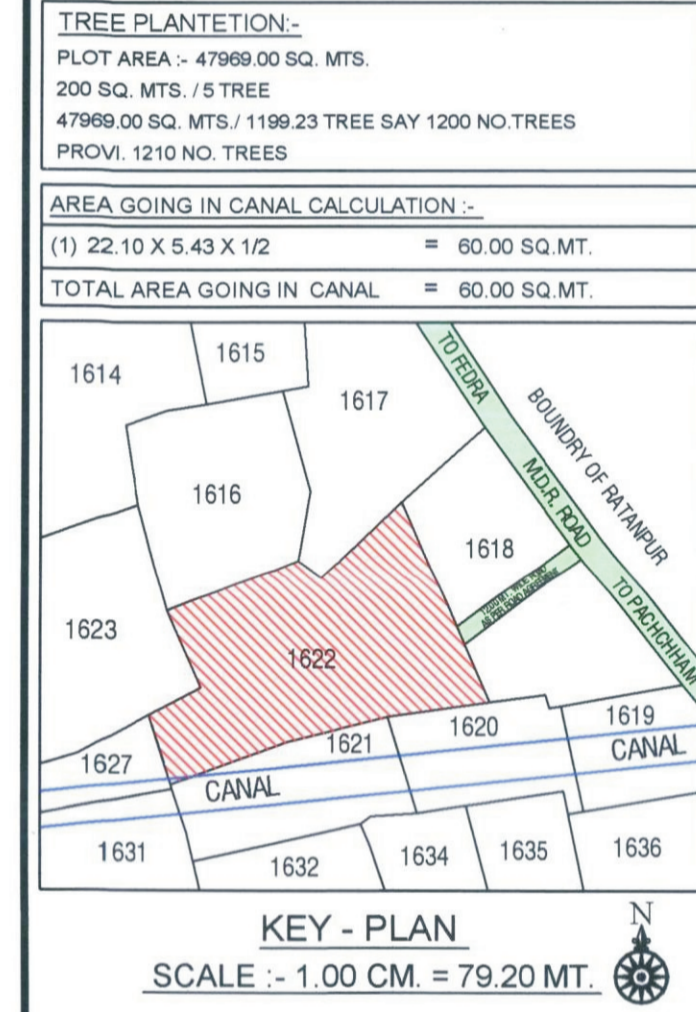
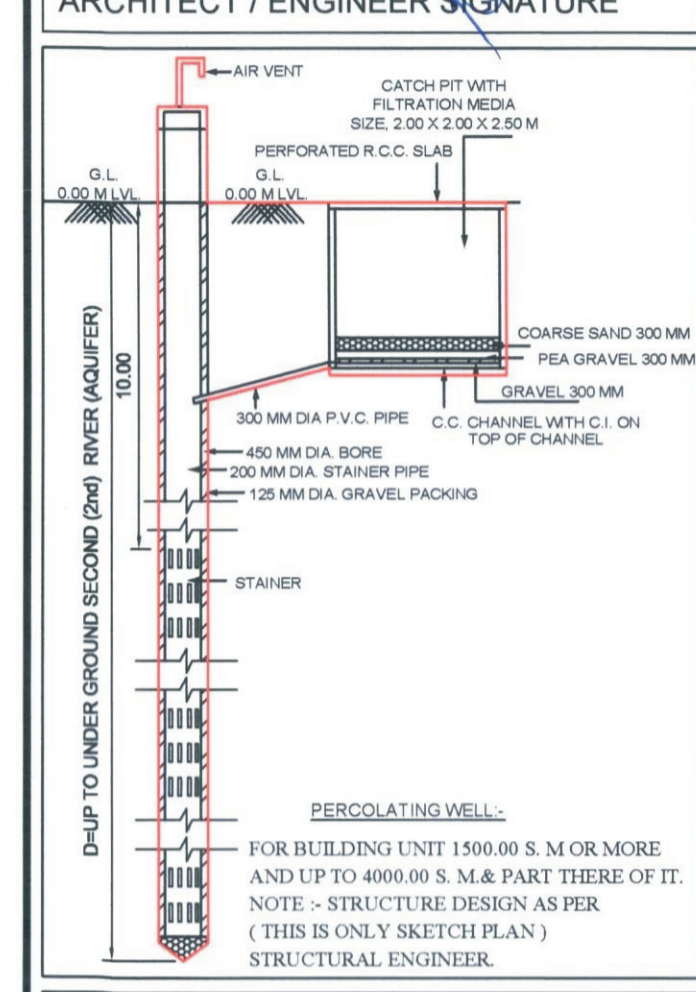

Table with 4 columns: USES, NO OF UNITS, NO OF USERS, SOAK WELL, SEPTIC TANK. Includes sub-tables for RESI and CLUB HOUSE.

Table with 4 columns: USES, NO OF UNITS, NO OF USERS, SOAK WELL, SEPTIC TANK. Includes sub-tables for CLUB HOUSE.

Table with 4 columns: BLOCK, GROUND, FIRST, SECOND, NO OF UNITS, TOTAL. Includes sub-tables for CLUBHOUSE.

REG. PERCOLATING WELL. PLOT AREA - 1500 TO 4000 SQ. MTs. PERCOLATING WELL. PLOT AREA - 47869.00 / 4000.00 SQ. MTs.

COMMON PLOT AREA CALCULATION

Table with 4 columns: C.P.1, C.P.2, C.P.3, C.P.4, C.P.5, C.P.6, C.P.7, C.P.8. Includes sub-tables for COMMON PLOT.

F.S.I. AREA TABLE

Table with 5 columns: BLOCK, GROUND, FIRST, SECOND, NO OF UNITS, TOTAL. Includes sub-tables for CLUBHOUSE.

OWNER IS FULLY RESPONSIBLE

Owner is fully responsible for the correct layout of the plots, D.P., OR T.P. Road, Alignment and Boundary of F.P. OR Sur. No. of the Lay-Out.

SUB PLOT AREA CALCULATION

Large table with columns: PLOT NO., CALCULATION, NET PLOT AREA, PROPOSED BUILT UP AREA, PERMI.F.S.I. @ 1.20, PROPOSED F.S.I. AREA, BALANCED F.S.I. AREA. Includes sub-tables for COMMON PLOT-1 to COMMON PLOT-8.



LAY OUT PLAN SCALE :- 1 CM. : 5.00 MT.

आपका ध्यान अत्यंत महत्वपूर्ण है कि आपका ध्यान रखना है कि इस योजना के तहत निर्माण कार्य के लिए आवश्यक सभी दस्तावेजों को संतुष्ट करना है।

PROPOSED LAY OUT PLAN SHOWING RESIDENTIAL (SUB-PLOTTING) ON NEW SURVEY NO.- 1622 OF OLD SURVEY NO.- 512

SCALE - 1.00 CM = 5.00 MT. LAY-OUT PLAN

Table with 2 columns: AREA TABLE, IN SQ.MT. Includes sub-tables for AREA GOING IN CANAL, REMAINING PLOT AREA, etc.

COLOUR NOTES: PROP WORK, SURVEY NO. BOUNDARY, ROAD, COMMON PLOT

COMMON PLOT-2 AREA = 1401.06 SQ. MT. PERMI.B.A IN COMMON PLOT - 2 @ 15% OF C.P. 1401.06 X 0.15 = 210.16 SQ. MT. BALANCE BUILT UP AREA ON COMMON PLOT = 52.50 SQ.MTS.

OWNER: CHANDUBHAI JASHRAJBHAI PATEL (VASOYA) MANOJ L. KANANI, KETAN K. PATEL, C.T. MURDHANA APPT. NIKOL AHMEDABAD, AUDA/LIC/ENG/734, AUDA/LIC/COW-I/625

ENGINEER: SUR. ENGG.:-

आपका ध्यान अत्यंत महत्वपूर्ण है कि आपका ध्यान रखना है कि इस योजना के तहत निर्माण कार्य के लिए आवश्यक सभी दस्तावेजों को संतुष्ट करना है।

AUTHORITY:-